

SECTIUNE / SECTION 1-1
Scara / Scale 1:20

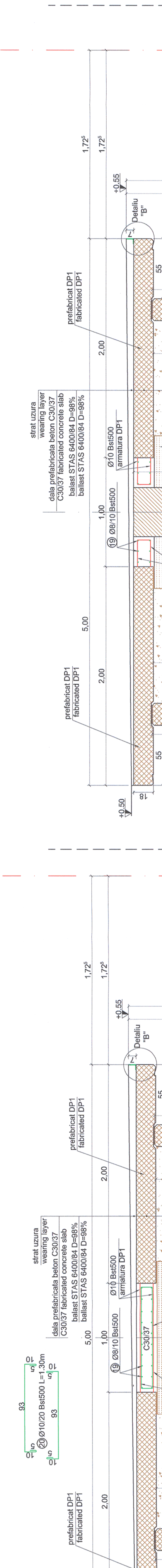

SECTIUNE / SECTION 2-2
Scara / Scale 1:20

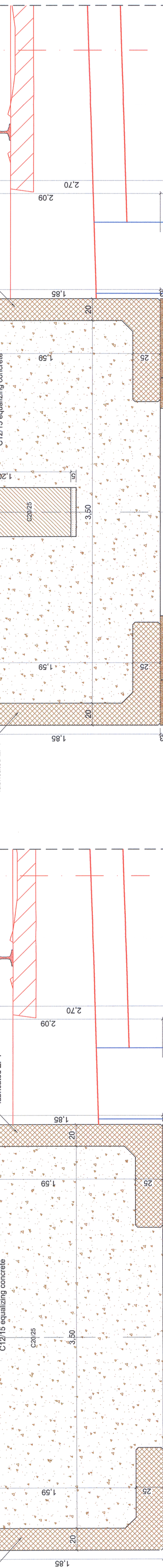

SECTIUNE / SECTION 2-2
Scara / Scale 1:20

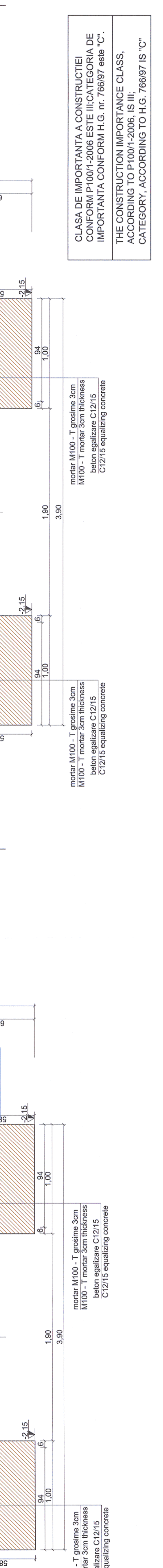

DETALIU / DETAIL "B"
Scara / Scale 1:10

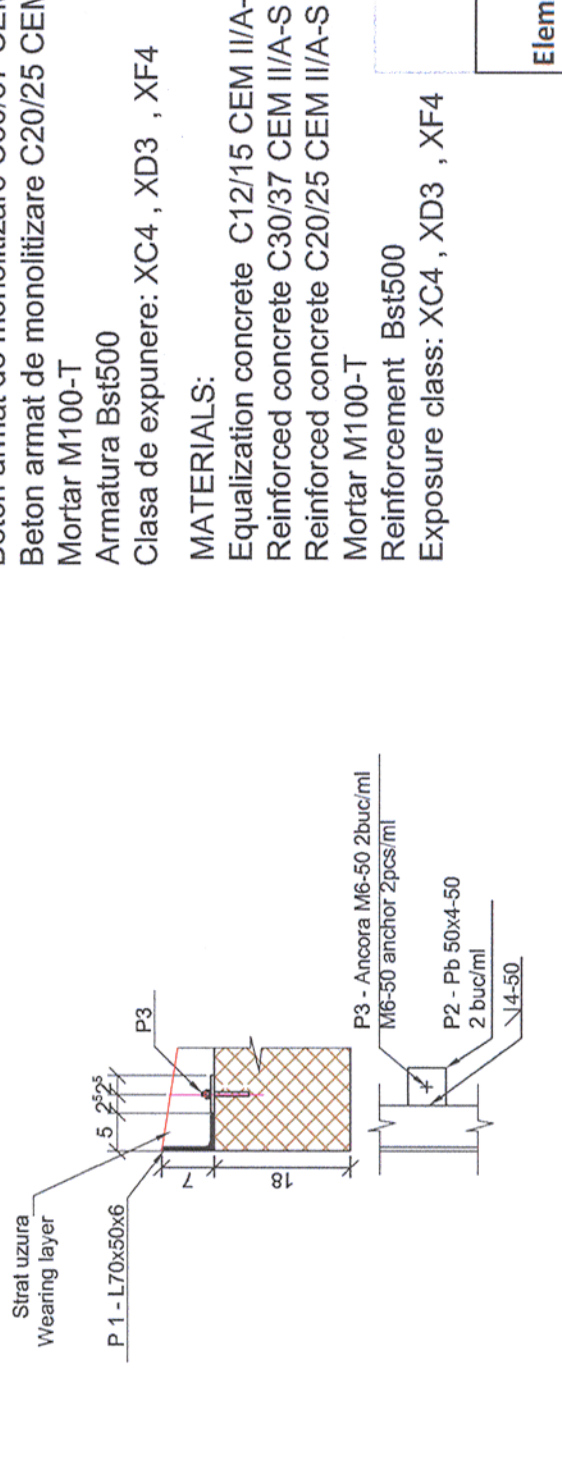

EXTRAS DE LAMINATE (pe ml de peron) /
Rolled steel extract (by ml platform)

Element / Position	Lungime / Length [m]	Bucati / Pieces	Greutate / Weight [Kg]		Calitate / Quality
			Pe buc	Total	
P1	L70x50x6	1	5.41	5.41	S255JR
P2	Pb 50x4-50	2	1.57	0.0785	S255JR
P3	M6-50	2	-	0.03	S255JR
Total / Total [Kg]			5.627	5.627	
Sudura / Welding [3%]			0.16881	0.16881	
Greutate Totala / Total weight [Kg]			5.79581	5.79581	

NOTE 1:
The following technology will be applied in case when the prefabricated elements from the line will be removed in order to execute the line works with heavy track machines:

- the asphalt uncovering in the concrete cast in position area between prefabricated elements (DP)
- removing the cast-in-place concrete
- cutting the reinforcements in the central area of the concrete cast in position (at min. 1.50 m from the platform edge)
- removing the prefabricated elements and storing them in the same section on the platform exterior side (the removed prefabricated unit is stored on the one which is not removed)
- track works execution
- renewing the platform by mounting prefabricated elements on the initial position
- while mounting the prefabricated elements on the platform it is ensured the continuity of reinforcement that were cut at point 3, by help of Bst500 welded fishplates having Ø 10mm and l = 250 mm
- the removed area is casted-in-place with concrete C 30/37 and the uncovered asphalt is renewed.

MATERIALE:
Beton de egalizare C12/15 CEM III/A-S 32.5 N ; sort 0-31; A/C : 0.75 ;
Beton armat de monolitizare C30/37 CEM III/A-S 42.5 N; sort 0-16; A/C : 0.55;
Mortar M100-T
Armatura Bst500
Clasa de expunere: XC4 , XD3 , XF4

MATERIALS:
Equalization concrete C12/15 CEM III/A-S 32.5 N ; sort 0-31; A/C : 0.75 ;
Reinforced concrete C30/37 CEM III/A-S 42.5 N; sort 0-16; A/C : 0.55;
Reinforced concrete C20/25 CEM III/A-S 42.5 N; sort 0-16; A/C : 0.55;
Mortar M100-T
Reinforcement Bst500
Exposure class: XC4 , XD3 , XF4



Element	Marca / Mark	Nr. Buc. / No. of pieces	Lungime / Length (m)	Bst500(S500) Ø8
Sectione 1-1	19	8	20.00	20.00
Sectione 2-2	20	10	1.30	13.00

Lungime totala pe diametre /
Total length on diameter (m)
Masa pe metru / Mass on meter (kg/m)
Masa pe diametre / Mass on diameter (kg)
Masa totala pe tip de otel /
Total mass on steel type (kg)

PROIECTANT / DESIGNER:
C. Teodorescu
R. Witan

Aprobat / Approved
Verificat / Expert Chele / Checked
Subcontractant / Subcontractor

01.2013
01.2013

Semnătura / Signature
A.M. Baicu
D. Oprescu

01.2013
01.2013

PROIECTUL / PROJECT
"Reabilitarea liniei c.f. Frontieră - Simeria, parte componentă a coridorului IV Pan - European pentru circulația trenurilor cu viteză maximă de 160 km/h"

Section 3: Guraasa - Simeria
Faza / Phase:
PTh+CS / TD+TS

Project 91
35311.1

Denumire desen / Drawing name:
Secțiune 1-1 zonă curentă peron 5.00m - stația Ila / Section 1-1 current area of platform 5.00m - Ila station
Secțiune 2-2 zonă șipă iluminat peron 5.00m - stația Ila / Section 2-2 lighting pole area of platform 5.00m - Ila station

Scara / Scale
1:10;1:20

Revizia / Revision
1/05.2013

Cod desen / Drawing Code
PT.03.03.22.RE.01.005

Nr / No
05/08

Acest plan anuleaza si inlocuieste planul nr. PT.03.03.22.RE.01.005 elaborat la data 01.2013.
This layout plan canceled and replaced layout plan no. PT.03.03.22.RE.01.005 prepared on 01.2013.

